

PLAN OF A PROPOSED G+III STORED RESIDENTIAL BUILDING U/S 393 (A) OF K.M.C. ACT, 1980, ALONG WITH K.M.C. BUILDING RULES 2009, AT PREMISES, NO. 462, KAILASH GHOSH ROAD, UNDER K.M.C. WARD NO.- 123, BR. NO. - XVI.

NAME OF OWNERS - SWAPAN BISWAS, GITA BISWAS

DRAWN BY - SOMNATH HALDER.

MASTER SHEET (SHEET 01 OF 02)

SCHEDULE OF DOORS & WINDOWS

TYPE	HEIGHT	WIDTH	MKD.
PANEL	2100	1200	DG
DO	2100	1000	D
DO	2100	900	D1
DO	2100	2100	D2
GLASSED	1200	750	W1
DO	1200	1500	W2
DO	1200	1200	W3
DO	1200	600	W4

STATEMENT OF THE PLAN PROPOSAL

- GROUND COVERAGE
- DETAILS OF RECORD DEED -
- DETAILS OF BOUNDARY DECLARATION -
- DETAILS OF POWER OF ATTORNEY DECL.
- TOTAL COVERED AREA EXCLUDING THE SPACES EXEMPTED IN THIS RULE
- TOTAL AREA EXEMPTED IN THIS RULE
- GROSS TOTAL COVERED AREA 565.868 SQ.M (INCLUDING THE SPACES EXEMPTED IN THIS RULE)
- TOTAL CAR PARKING AREA - 80.347 SQ.M (MANDATORY)
- NO. OF CAR PARKING SPACES - 2 NOS. PERMISSIBLE = 2 NOS. PROVIDED = 2 NOS.
- NO. OF STORED = G+III STORED.
- NO. OF TENAMENT = 7 NOS.
- SIZE OF TENAMENT = BELOW 90 SQ.M - 1 NO.
- 90 TO 100 SQ.M - 4 NOS.
- 75 TO 100 SQ.M - 2 NOS.
- BUSINESS COVER AREA - 18.367 SQ.M
- 11 BUSINESS CARPET AREA - 13.009 SQ.M
- A.A.I NO. ID. BEHA/EAST/B/112622/637601, DATED - 01/08/2022

- ASSESSOR NO. - 41-123-09-0948-1
- CD VOLUME NO. 15 (a) DATE - 30.05.2006
- PAGES - 7891 TO 7713, A.D.S.R., BENGALURU.
- DEED NO. - 16071610 (a) BOOK NO. - 1
- VOLUME NO. - 16072018 (a) DATE - 13.12.2018
- PAGES - 37788 AT A.D.S.R., BENGALURU.
- DEED NO. - 16071610 (a) BOOK NO. - 1
- VOLUME NO. - 16072018 (a) DATE - 13.12.2018
- PAGES - 37788 AT A.D.S.R., BENGALURU.
- DEED NO. - 16071610 (a) BOOK NO. - 1
- VOLUME NO. - 16072018 (a) DATE - 13.12.2018
- PAGES - 37788 AT A.D.S.R., BENGALURU.
- DEED NO. - 16071610 (a) BOOK NO. - 1
- VOLUME NO. - 16072018 (a) DATE - 13.12.2018
- PAGES - 37788 AT A.D.S.R., BENGALURU.
- DEED NO. - 16071610 (a) BOOK NO. - 1
- VOLUME NO. - 16072018 (a) DATE - 13.12.2018
- PAGES - 37788 AT A.D.S.R., BENGALURU.
- DEED NO. - 16071610 (a) BOOK NO. - 1
- VOLUME NO. - 16072018 (a) DATE - 13.12.2018
- PAGES - 37788 AT A.D.S.R., BENGALURU.

- GRADE OF CONCRETE IS - M 20.
- GRADE OF STEEL FE - 500.
- BEARING CAPACITY OF SOIL AS PER SOIL REPORT
- 200 THK. BRICK WORK WALL IN C.M. - 1:4.
- 125 & 75 THK. BRICK WORK WALL
- IN C.M. - 1:4.
- ALL OTHER SPECIFICATION AS PER I.S. CODE.

DECL. OF GEOTECHNICAL ENGINEER
 Gopal Chandra Bag
 G.I. NO - 1/42

DECL. OF L.B.S.
 Gopal Chandra Bag
 L.B.S. NO - 1/1552

DECL. OF E.S.E.
 Gopal Chandra Bag
 E.S.E. NO - 1/206

DECL. OF POWER OF ATTORNEY
 Gopal Chandra Bag
 E.S.E. NO - 1/206

DECL. OF POWER OF ATTORNEY
 Gopal Chandra Bag
 E.S.E. NO - 1/206

DECL. OF POWER OF ATTORNEY
 Gopal Chandra Bag
 E.S.E. NO - 1/206

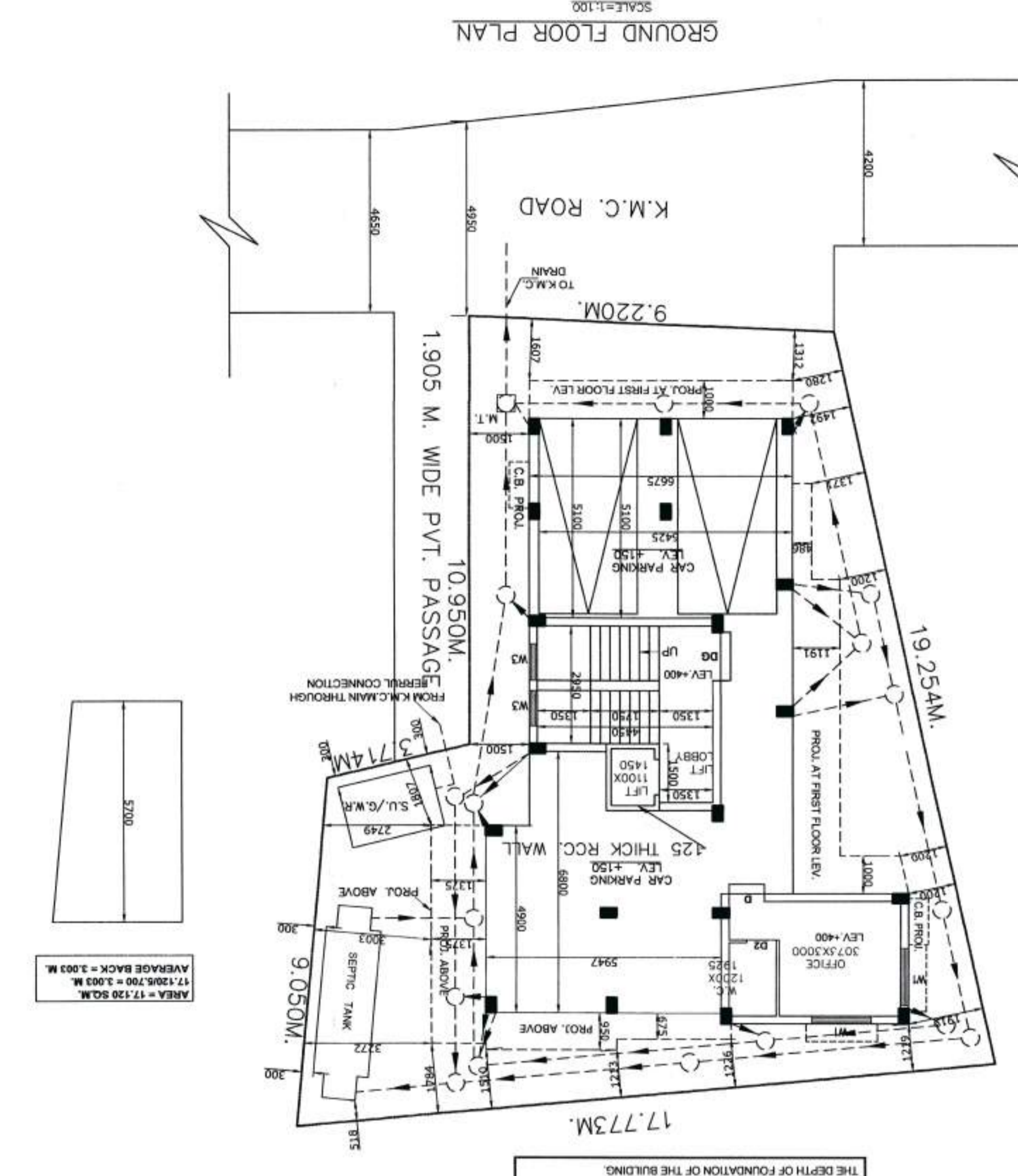
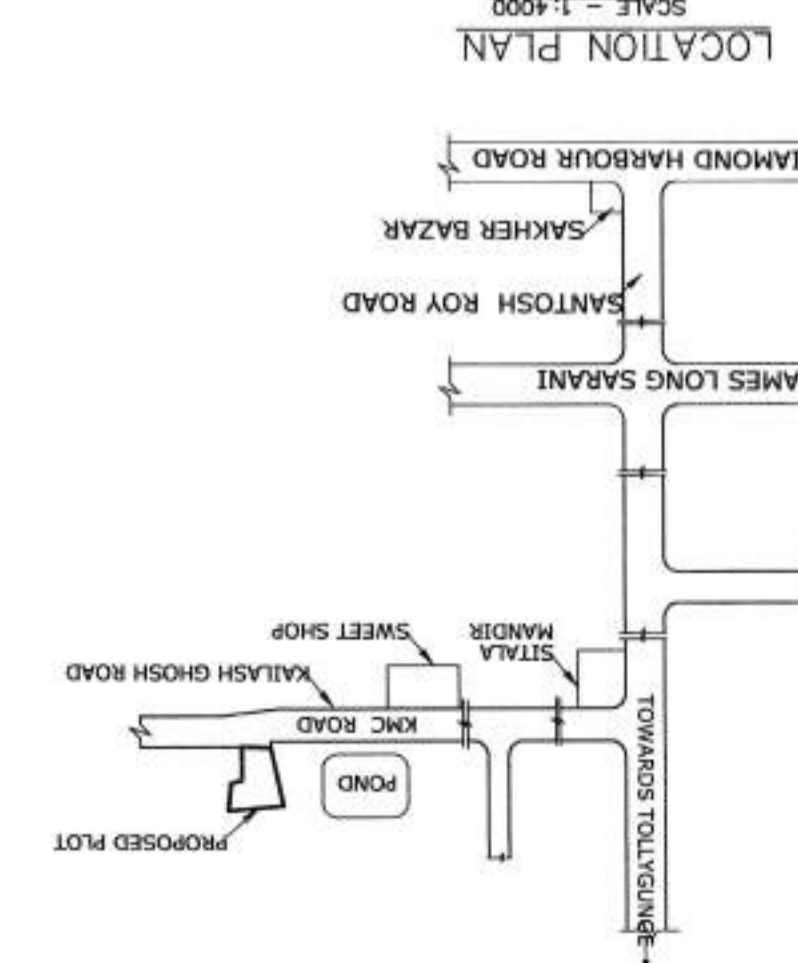
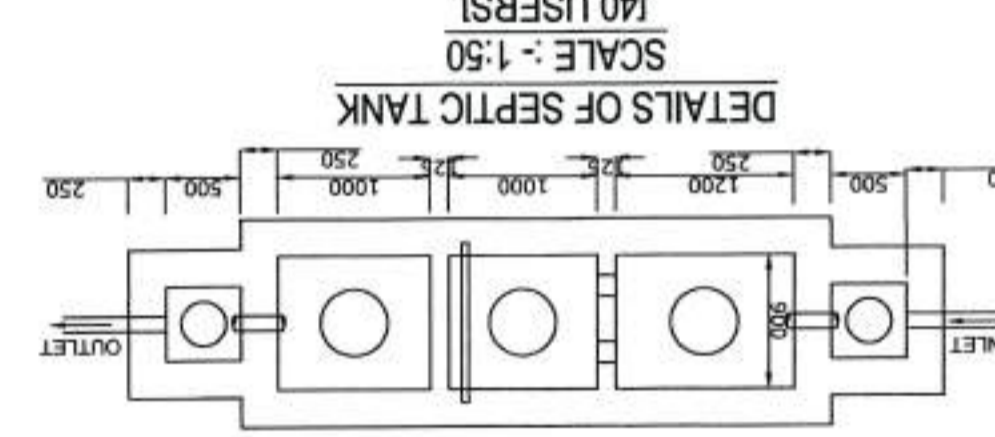
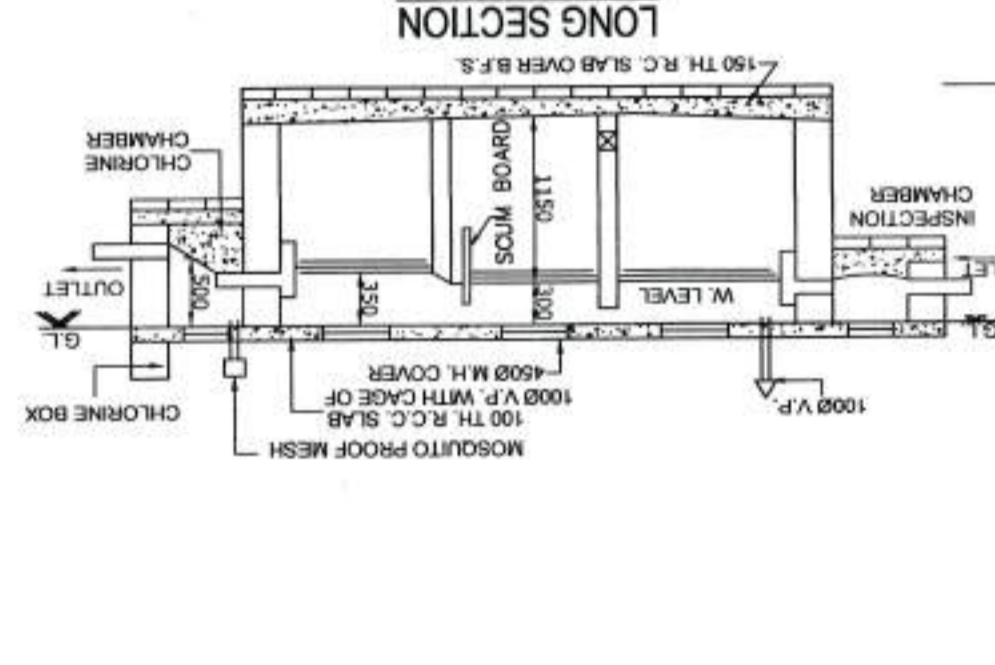
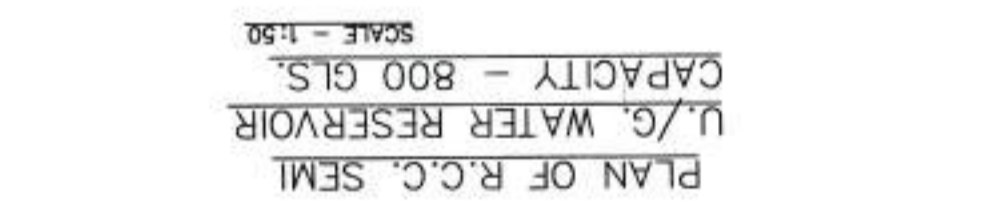
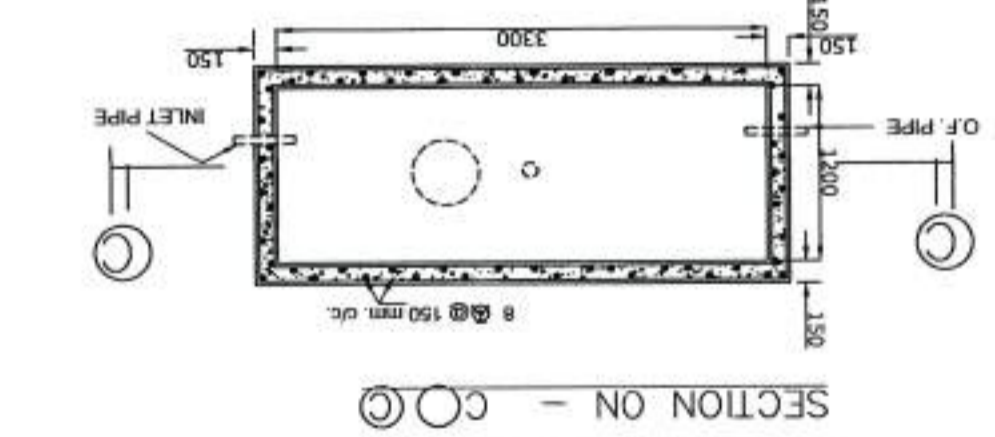
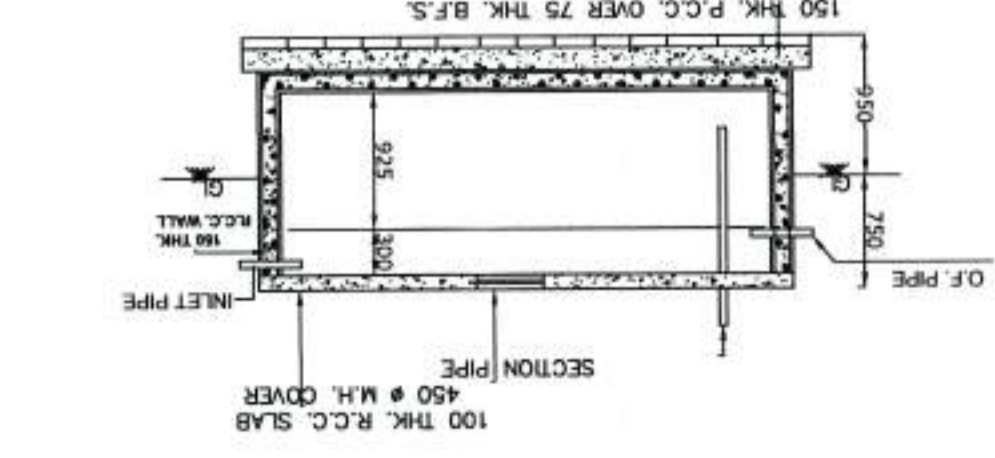

AREA = 17.138 SQ.M
 17.120/1.700 = 10.03 M
 AVERAGE BACK = 3.093 M

THE DEPTH OF SEPTIC TANK & S.U.W.R. SHOULD NOT EXCEED THE DEPTH OF FOUNDATION OF THE BUILDING.